

**This electronic collection of documents is provided
for the convenience of the user
and is Not a Certified Document –**

**The documents contained herein were originally issued
and sealed by the individuals whose names and license
numbers appear on each page, on the dates appearing
with their signature on that page.**

**This file or an individual page
shall not be considered a certified document.**

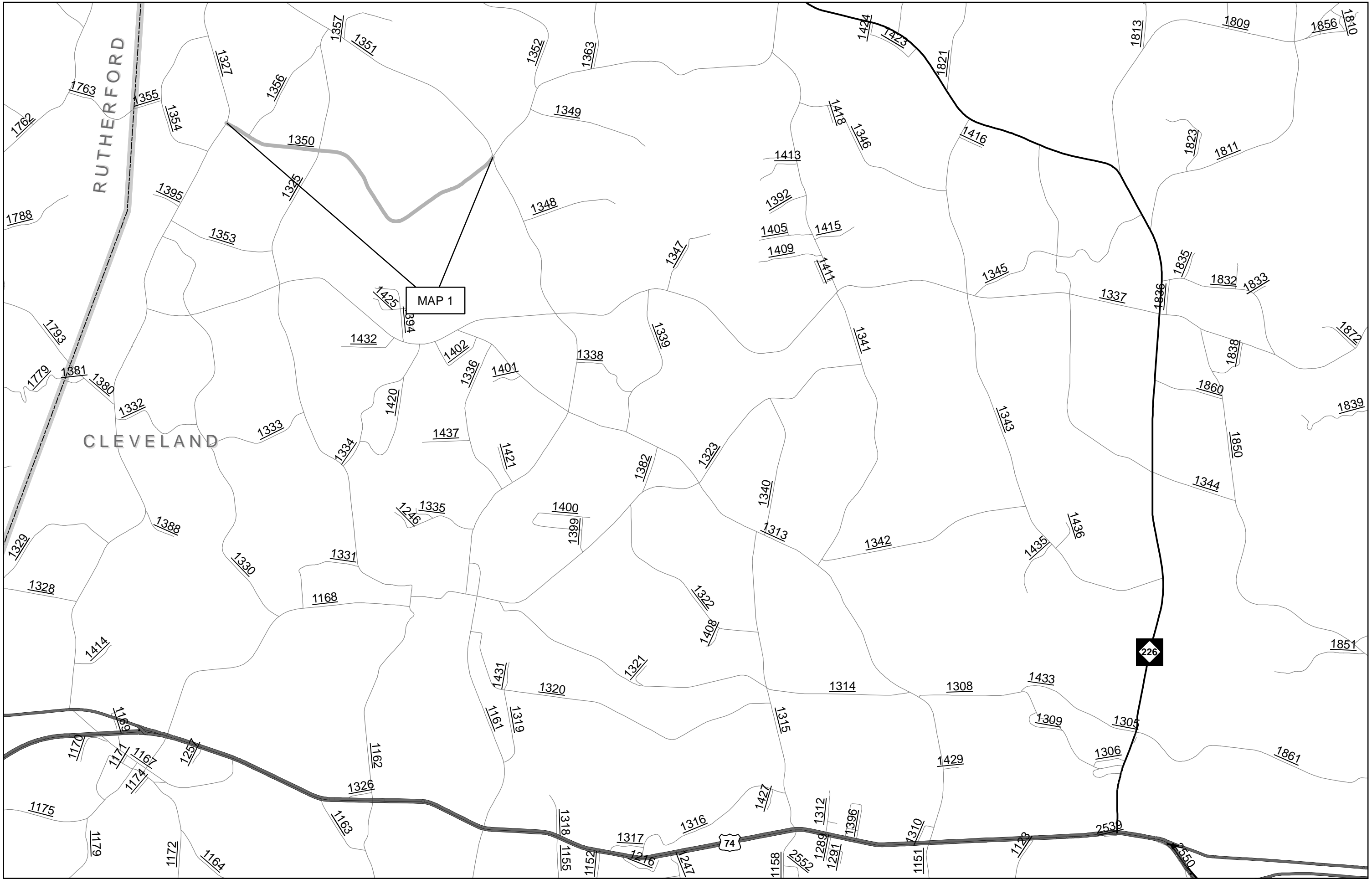

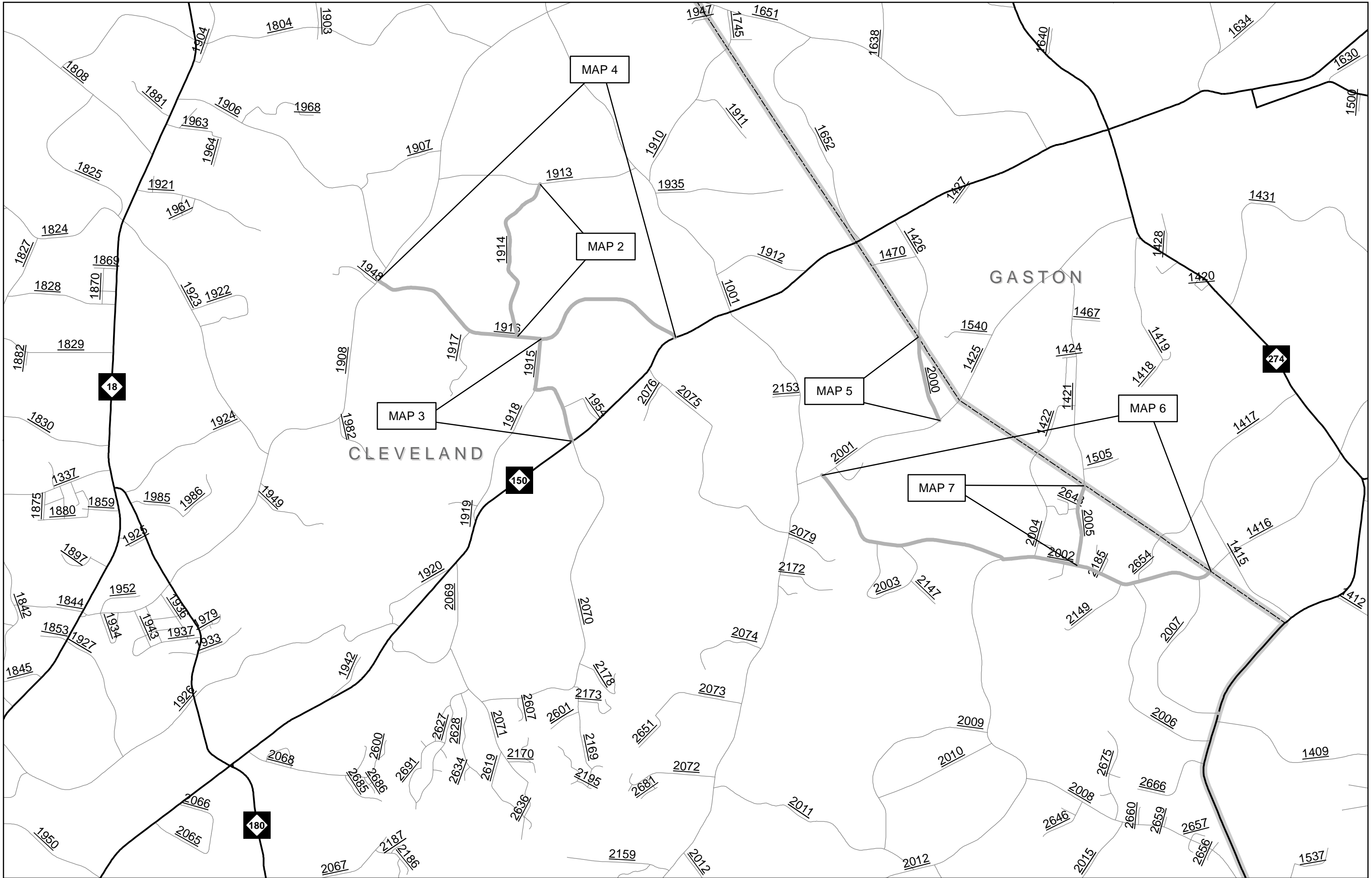

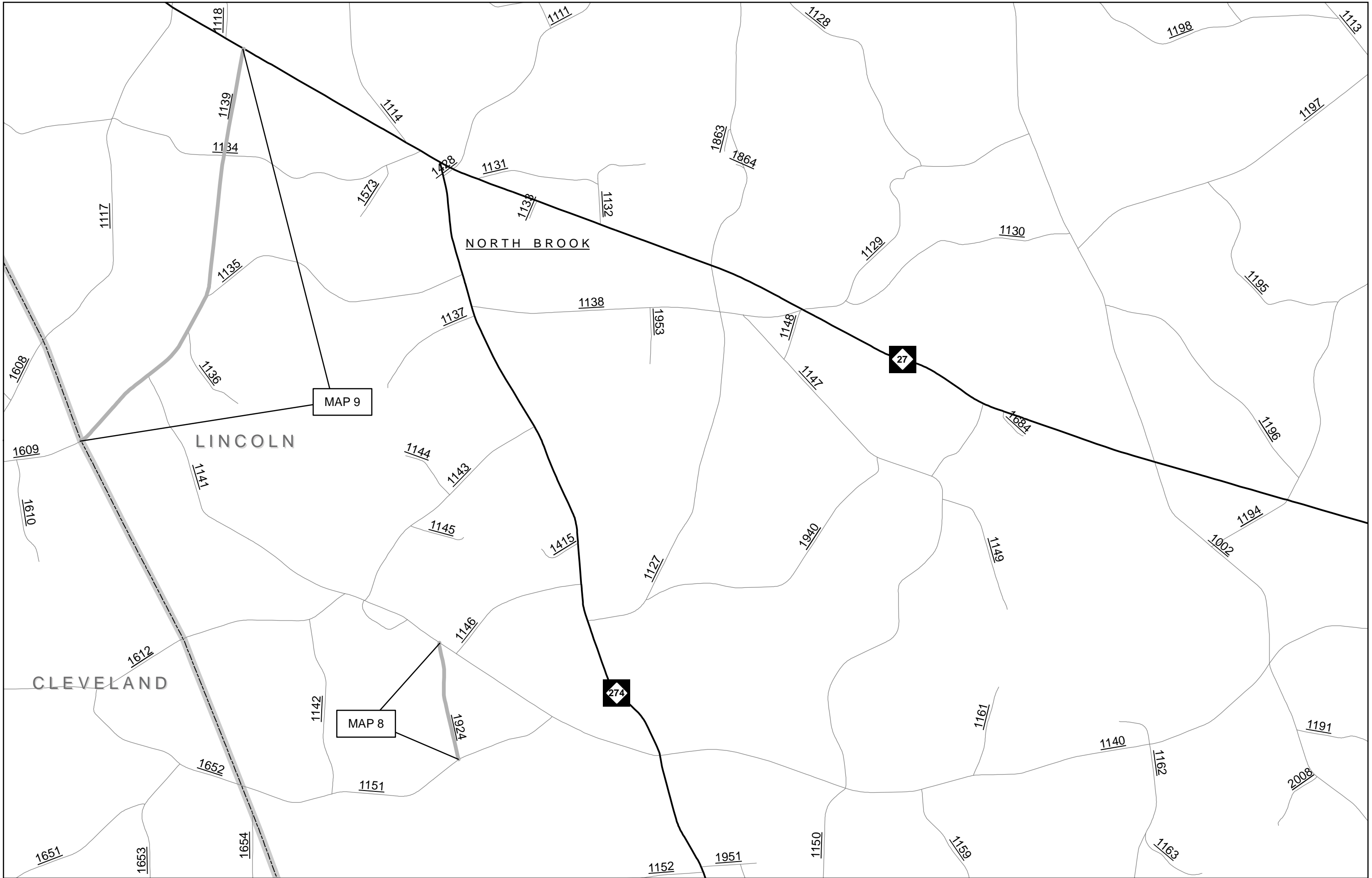

PAVEMENT SCHEDULE	
F	ASPHALT SURFACE TREATMENT, DOUBLE SEAL, USING A TOP LAYER OF LIGHTWEIGHT AGGREGATE AND A BOTTOM LAYER OF #78M AGGREGATE
G	ASPHALT SURFACE TREATMENT, FOG SEAL USING A TARGET APPLICATION RATE OF 0.12 GAL/SY, +/- 0.03 GAL/SY

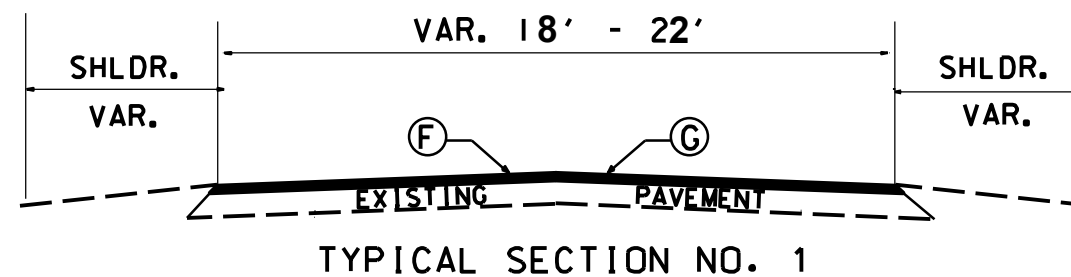

2022-2023
 PVMT. PRESERVATION
 CLEVELAND & LINCOLN
 COUNTIES

PROJECT NO.	SHEET NO.	TOTAL NO.
2023CPT.12.08.20232,		
2023CPT.12.08.20552		

SUMMARY OF QUANTITIES

PROJECT NO	COUNTY	MAP NO	ROUTE	DESCRIPTION	TYP NO	LANES	LANE TYPE	FINAL SURFACE TESTING REQUIRED	WARM MIX ASPHALT REQUIRED	LENGTH	WIDTH	1803500000-E	1820000000-E	1838000000-E	2143000000-E	
												ASPHALT SURFACE TREATMENT, DOUBLE SEAL	ASPHALT SURFACE TREATMENT, FOG SEAL	EMULSION FOR ASPHALT SURFACE TREATMENT	BLOTTING SAND	
												MI	FT	SY	SY	GAL
2023CPT.12.08.20232	Cleveland	1	SR 1350 (REHOBETH CH. RD.)	SR 1327 (MOORESBORO RD.) TO SR 1351 (NEW HOUSE RD.)	1	2	2WU	NO	NO	2.37	VAR. 18-21	29,824	29,824	14,912	15	
2023CPT.12.08.20232	Cleveland	2	SR 1914 (DEAL RD.)	SR 1916 (SPERLINGS DR.) TO SR 1913 (A.A. BARRETT RD.)	1	2	2WU	NO	NO	1.25	19	15,326	15,326	7,663		
2023CPT.12.08.20232	Cleveland	3	SR 1915 (RIDGE/PINEDALE/SPERLING RD.)	NC 150 TO NC 150	1	2	2WU	NO	NO	2.1	VAR. 20-22	26,180	26,180	13,090		
2023CPT.12.08.20232	Cleveland	4	SR 1916 (SPERLING DR.)	SR 1915 (PINEDALE RD.) TO SR 1908 (NEW PROSPECT CH. RD.)	1	2	2WU	NO	NO	1.32	20	17,037	17,037	8,518		
2023CPT.12.08.20232	Cleveland	5	SR 2000 (PAUL H. BEAM RD.)	SR 2001 (W. OLD POST RD.) TO GASTON COUNTY	1	2	2WU	NO	NO	0.61	VAR. 19-20	7,676	7,676	3,838		
2023CPT.12.08.20232	Cleveland	6	SR 2002 (TOBE BRIDGE RD./MARYS GROVE CH. RD.)	SR 2001 (W. OLD POST RD.) TO GASTON COUNTY	1	2	2WU	NO	NO	3.16	19	38,746	38,746	19,373		
2023CPT.12.08.20232	Cleveland	7	SR 2005 (MARYS GROVE RD.)	SR 2002 (MARYS GROVE CH. RD.) TO GASTON COUNTY	1	2	2WU	NO	NO	0.56	18	6,854	6,854	3,427		
TOTAL FOR PROJ NO. 2023CPT.12.08.20232											11.37		141,643	141,643	70,821	15
2023CPT.12.08.20552	Lincoln	8	SR 1924 (BROWN RD.)	SR 1140 (FLAY RD.) TO SR 1151 (HULL RD.)	1	2	2WU	NO	NO	0.64	20	8,260	8,260	4,130		
2023CPT.12.08.20552	Lincoln	9	SR 1139 (DAVIDS CHAPEL RD.)	NC 27 TO CLEVELAND COUNTY	1	2	2WU	NO	NO	2.4	18	27,878	27,878	13,939	15	
2023CPT.12.08.20552	Lincoln	10	SR 1166 (ISHMAEL BEAM ROAD)	NC 182 TO SR 1642 (TOT DELINGER RD.)	1	2	2WU	NO	NO	1.46	20	18,844	18,844	9,422		
2023CPT.12.08.20552	Lincoln	11	SR 1175 (BOY SCOUT RD.)	SR 1236 (RIVER VIEW RD.) TO SR 2098 (OLD HWY 150)	1	2	2WU	NO	NO	1.95	20	25,168	25,168	12,584		
2023CPT.12.08.20552	Lincoln	12	SR 1228 (OLD LINCOLNTON CROUSE RD.)	NC 150 TO NC 182	1	2	2WU	NO	NO	2.65	18	30,782	30,782	15,391		
TOTAL FOR PROJ NO. 2023CPT.12.08.20552											9.1		110,932	110,932	55,466	15
GRAND TOTAL											20.47		252,575	252,575	126,287	30

PROJECT NO.	SHEET NO.	TOTAL NO.
2023CPT.12.08.20232, 2023CPT.12.08.20552		

THERMOPLASTIC AND PAINT QUANTITIES

PROJECT NO	COUNTY	MAP NO	ROUTE	DESCRIPTION	TYP NO	LANES	LANE TYPE	LENGTH		WIDTH	4413000000-E	4457000000-N	4705000000-E	4710000000-E	4721000000-E	4810000000-E	4810000000-E	4891000000-E	4870000000-E	4875000000-E
								MI	FT		WORK ZONE ADVANCE/GENERAL WARNING SIGNING	TEMPORARY TRAFFIC CONTROL	16" X 90 M WHITE THERMO	24" X 90 M WHITE THERMO	THERMO MSG RXR 90 M	4" YELLOW PAINT	4" WHITE PAINT	16" PAVEMENT MARKING LINE REMOVAL	24" PAVEMENT MARKING LINE REMOVAL	REMOVAL OF PAVEMENT MARKING SYMBOLS & CHARS.
											SF	LS	LF	LF	EA	LF	LF	LF	LF	EA
2023CPT.12.08.20232	Cleveland	1	SR 1350 (REHOBETH CH. RD.)	SR 1327 (MOORESBORO RD.) TO SR 1351 (NEW HOUSE RD.)	1	2	2WU	2.37	18		148	1				49,948	51,002			
2023CPT.12.08.20232	Cleveland	2	SR 1914 (DEAL RD.)	SR 1916 (SPERLINGS DR.) TO SR 1913 (A.A. BARRETT RD.)	1	2	2WU	1.25	18		116					26,900	26,900			
2023CPT.12.08.20232	Cleveland	3	SR 1915 (RIDGE/PINEDALE/SPERLING RD.)	NC 150 TO NC 150	1	2	2WU	2.1	18		148		100	70	4	45,192	45,192	100	70	4
2023CPT.12.08.20232	Cleveland	4	SR 1916 (SPERLING DR.)	SR 1915 (PINEDALE RD.) TO SR 1908 (NEW PROSPECT CH. RD.)	1	2	2WU	1.32	18		116					28,406	28,406			
2023CPT.12.08.20232	Cleveland	5	SR 2000 (PAUL H. BEAM RD.)	SR 2001 (W. OLD POST RD.) TO GASTON COUNTY	1	2	2WU	0.61	18		84					13,127	13,127			
2023CPT.12.08.20232	Cleveland	6	SR 2002 (TOBE BRIDGE RD./MARYS GROVE CH. RD.)	SR 2001 (W. OLD POST RD.) TO GASTON COUNTY	1	2	2WU	3.16	18		180					68,003	68,003			
2023CPT.12.08.20232	Cleveland	7	SR 2005 (MARYS GROVE RD.)	SR 2002 (MARYS GROVE CH. RD.) TO GASTON COUNTY	1	2	2WU	0.56	18		84					12,051	12,051			
TOTAL FOR PROJ NO. 2023CPT.12.08.20232								11.37			876	1	100	70	4	243,627	244,681	100	70	4
2023CPT.12.08.20552	Lincoln	8	SR 1924 (BROWN RD.)	SR 1140 (FLAY RD.) TO SR 1151 (HULL RD.)	1	2	2WU	0.64	20		84					13,773	13,773			
2023CPT.12.08.20552	Lincoln	9	SR 1139 (DAVIDS CHAPEL RD.)	NC 27 TO CLEVELAND COUNTY	1	2	2WU	2.4	18		148					51,648	51,648			
2023CPT.12.08.20552	Lincoln	10	SR 1166 (ISHMAEL BEAM ROAD)	NC 182 TO SR 1642 (TOT DELINGER RD.)	1	2	2WU	1.46	20		116					31,419	31,419			
2023CPT.12.08.20552	Lincoln	11	SR 1175 (BOY SCOUT RD.)	SR 1236 (RIVER VIEW RD.) TO SR 2098 (OLD HWY 150)	1	2	2WU	1.95	20		116		100	70	4	41,964	41,964	100	70	4
2023CPT.12.08.20552	Lincoln	12	SR 1228 (OLD LINCOLNTON CROUSE RD.)	NC 150 TO NC 182	1	2	2WU	2.65	18		148					55,208	57,028			
TOTAL FOR PROJ NO. 2023CPT.12.08.20552								9.1			612		100	70	4	194,012	195,832	100	70	4
GRAND TOTAL								20.47			1,488	1	200	140	8	437,639	440,513	200	140	8

SIGNING FOR ASPHALT SURFACE TREATMENT

LEGEND

- ◻ PORTABLE SIGN
- ┌ STATIONARY SIGN
- ← DIRECTION OF TRAFFIC FLOW

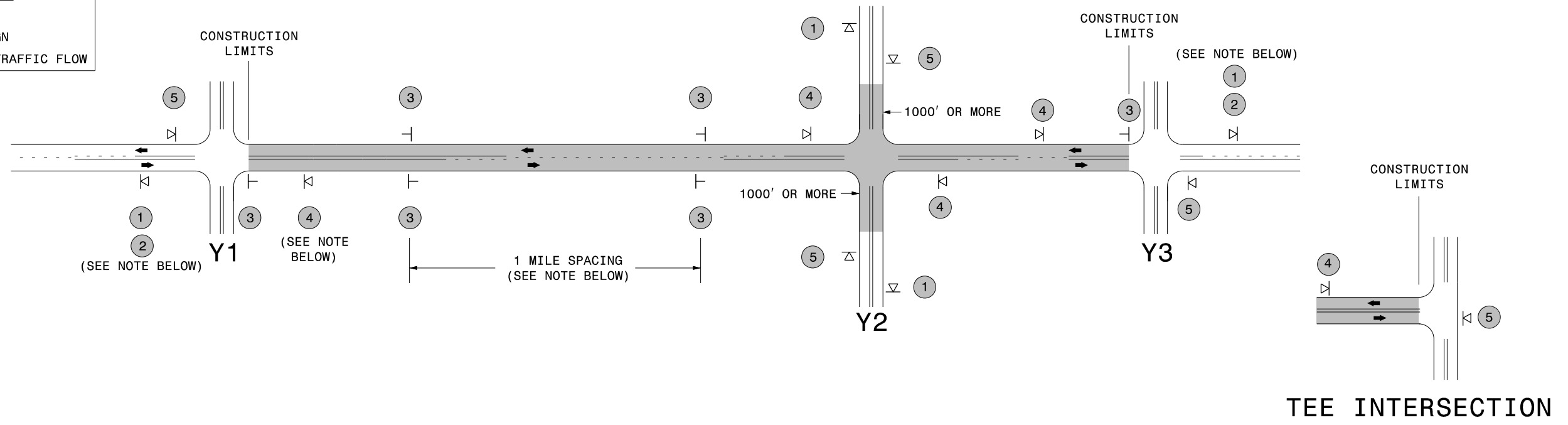

MAINLINE (-L-) SIGNING

-Y- LINE SIGNING

SIGNING NOTES AND PLACEMENT PER DIRECTION	1	 W20-1 48" X 48"	<ul style="list-style-type: none"> - PLACE 1000' PRIOR TO BEGINNING OF CONSTRUCTION LIMITS. ONLY USED ON -Y- LINES IF RESURFACING LIMITS EXTEND 1000' ALONG -Y- LINE. 	<p>STATIONARY SIGNING NOT REQUIRED FOR THE FOLLOWING -Y- LINE CONDITIONS:</p> <ol style="list-style-type: none"> 1) LESS THAN 1000' OF RESURFACING ALONG -Y- LINE 2) SUBDIVISION ROADS 3) DEAD END ROADS <p>WHEN PAVING/CONSTRUCTION ACTIVITIES PROCEED ACROSS AN UNSIGNED -Y- LINE, PORTABLE ADVANCE WARNING SIGNS SHALL BE USED ALONG THE -Y- LINE AS SHOWN BELOW. REMOVE UPON COMPLETION OF WORK.</p> <div style="display: flex; justify-content: space-around; align-items: center;"> <div style="text-align: center;"> W20-1 48" X 48" PLACED 500' IN ADVANCE OF FLAGGER. </div> <div style="text-align: center;"> W20-7 A 48" X 48" PLACED 250' IN ADVANCE OF FLAGGER. </div> </div>
	2	 W7-3qP 24" X 18"	<ul style="list-style-type: none"> - SIGN #2 ONLY USED WHEN RESURFACING LIMITS ARE 2 OR MORE MILES IN LENGTH. ROUND UP TO THE NEAREST WHOLE NUMBER. DO NOT USE FRACTIONAL OR DECIMAL NUMBERS. 	
	3	 W8-7 48" X 48"	<ul style="list-style-type: none"> - ALTERNATE THE FOLLOWING TWO SIGNS: - STARTING WITH "LOOSE GRAVEL" (W8-7) FOLLOWED BY "UNMARKED PAVEMENT". - PLACE INITIALLY AT THE CONSTRUCTION LIMITS AND SPACED 1 MILE APART THEREAFTER. 	
		 SP 48" X 48"	<ul style="list-style-type: none"> - AT TEE INTERSECTIONS INSTALL INITIALLY 0.5 MILE FROM INTERSECTION AND SPACE 1 MILE APART THEREAFTER. 	
	4	 SP 13106 48" X 48"	<ul style="list-style-type: none"> - THESE ARE FOR -Y- LINES THAT ARE "THROUGH" ROADWAYS. DEAD END AND SUBDIVISION ROADS ARE NOT "THROUGH" ROADWAYS. - INSTALL 500' +/- FROM EACH -Y- LINE APPROACH AS SHOWN ABOVE. - FOR MULTIPLE -Y- LINES THAT ARE SEPARATED BY 0.25 MILES OR LESS, TREAT AS A SINGLE UNIT AND INSTALL WITHIN 500' OF EACH APPROACH. - A MAXIMUM OF 2 SIGN SETS PER MILE. DO NOT INSTALL WHEN -Y- LINES ARE WITHIN 0.5 MILES FROM "END ROAD WORK" SIGN. 	
5	 G20-2 A 48" X 24"	<ul style="list-style-type: none"> - PLACE 500' FOLLOWING THE END OF CONSTRUCTION LIMITS OR AS SHOWN WHEN WORK ENDS AT A 3-WAY TEE INTERSECTION. 		

THE ABOVE SIGNS ARE ALL THAT ARE REQUIRED FOR A CONTRACTOR TO BEGIN A RESURFACING CONTRACT. ANY ADDITIONAL SIGNS REQUESTED BY NCDOT DIVISIONS SHALL BE INSTALLED WITHIN 7 BUSINESS DAYS OF THE START OF CONTRACT WORK.

MAPS LESS THAN 2 MILES

FOR AST RESURFACING MAPS WITH CONSTRUCTION LIMITS LESS THAN 2 MILES IN LENGTH, USE A STATIONARY "LOOSE GRAVEL" SIGN AT THE BEGINNING CONSTRUCTION LIMIT FOLLOWED BY AN "UNMARKED PAVEMENT" SIGN MIDWAY THROUGH AND AN "END ROAD WORK" SIGN AT THE END CONSTRUCTION LIMIT.

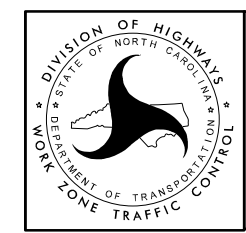

**ADVANCE WARNING SIGNS
FOR
2-LANE ROADWAY
ASPHALT SURFACE TREATMENT**

5/12/2017 S:\TUXWZTC\Resurfacing\2L2W & AST Resurfacing Details\Resurfacing_AdvWarn_2Ln - AST.dgn User:kedais